



POLY-COUSTIX®

BY SOUND SEAL

Distributed by:

WALLWORKS. ACOUSTIC. ARCHITECTURAL. PRODUCTS. INC.

sales@wallworks.com



PET | Polyester Acoustical Products

PET | Polyester Acoustical Products

PLEX BOARD™

VERTEX BAFFLE™

VERTEX SLIM™

OBLIX™

STRATUX CLOUD™

TETRIX™

TETRIX-AIR™

TRI-HEX™

DIVIDEX™ PANEL

DIVIDEX™ SCREEN

Acoustical Design Beyond Expectation.

Our Poly-Coustix® line of PET products is the perfect combination of innovative design and quality acoustical performance. With multiple color and configuration options, there are endless creative solutions for your space.

Color Chart and Dividex Panel/Screen Pattern Options Shown on Back Inside Cover.

POLY-COUSTIX®
BY SOUND SEAL

Distributed by:
WALLWORKS. ACOUSTIC. ARCHITECTURAL. PRODUCTS. INC.
sales@wallworks.com



PLEX BOARD™

FEATURES:

- Resists Mold, Mildew & Bacteria
- High Tackability
- Impact Resistant
- Hypo Allergenic, Dust-Free & Formaldehyde-Free
- Easy to Handle & Simple to Apply

COMPOSITION:

- 100% Polyethylene Terephthalate (PET)
- 55% Recycled Content

ENVIRONMENTAL FACTORS:

- 100% Recyclable
- Low VOC Emissions
- LEED - MRc4

SPECIFICATIONS:

Standard Board Size: 48" x 96" **

Thickness Options: 9mm, 12mm

Weight: 9mm: .27 lbs/SF, 12mm: .44 lbs/SF

Fire Rating: Class A per ASTM E-84, based on 9mm white

** Board Size 48" x 95-1/4" #30 Blue, #41 Marigold, #35 Speckled Earth & #34 Pure Gray

ACOUSTICAL DATA

Frequency (Hz)	125	250	500	1000	2000	4000	NRC
9mm Thickness	.04	.04	.16	.40	.63	.82	.30
9mm w/ 2" Air Gap	.07	.13	.42	.79	.89	.76	.55
9mm w/ 4" Air Gap	.14	.32	.73	.92	.72	.88	.65
18mm Thickness	.05	.12	.39	.74	.95	1.04	.55

9mm is tested as Type "A" Mounting, 9mm w/ 2" gap is tested as Type "F-50" Mounting, 9mm w/ 4" gap is tested as Type "F-100" Mounting, 18mm is tested as Type "A" Mounting

VERTEX BAFFLE™

FEATURES:

- Easy Install
- Choice of 35 Colors
- Lightweight and Easy to Handle
- Linear Layout
- Modern Design
- Excellent Acoustical Values
- 4' and 8' Lengths
- Custom Sizes Available

SPECIFICATIONS

Standard Baffle Sizes (WxH):	48"x 12", 48"x 16", 48"x 24" 96"x 12", 96"x 16", 96"x 24"
Thickness:	2-3/4"
Weight:	1.5 lbs/SF
Fire Rating:	Class A per ASTM E-84

HARDWARE OPTIONS

Product can be installed with your choice of either aircraft cable or threaded rod attachments.

ACOUSTICAL DATA

Frequency (Hz)	125	250	500	1000	2000	4000	SABINS
2-3/4" Thickness	2.94	4.45	7.05	10.62	12.61	13.64	

Frequency (Hz)	125	250	500	1000	2000	4000	NRC
2-3/4" Thickness	.38	.57	.90	1.36	1.61	1.74	1.10

Based on Baffle size 4' x 2' with Type "J" Mounting. Sabins are based on Sabins per Object, NRC is an equivalent number based on one face of one panel



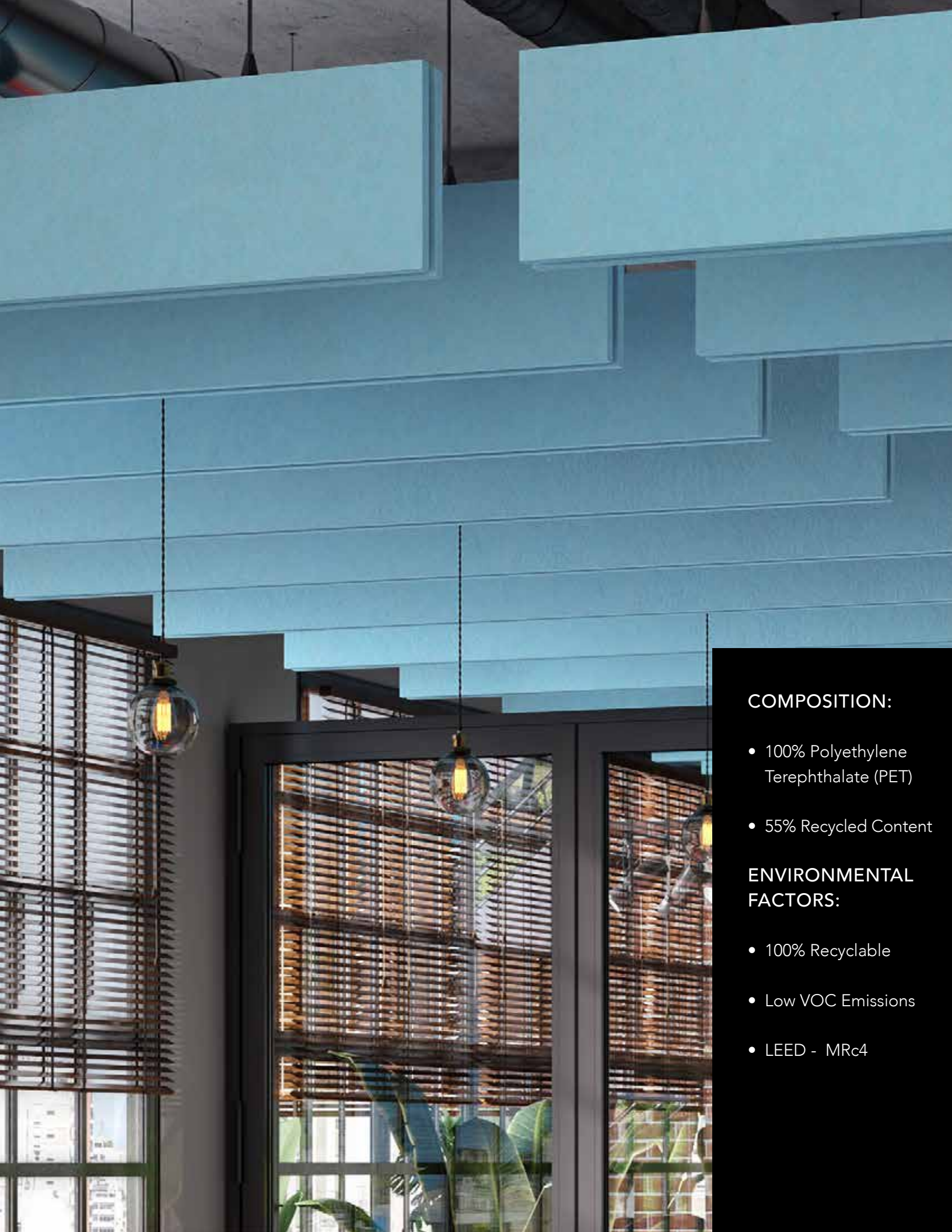

COMPOSITION:

- 100% Polyethylene Terephthalate (PET)
- 55% Recycled Content

ENVIRONMENTAL FACTORS:

- 100% Recyclable
- Low VOC Emissions
- LEED - MRc4

VERTEX SLIM™

FEATURES:

- Easy Install
- Choice of 35 Colors
- Lightweight and Easy to Handle
- Linear Layout
- Modern Design
- Excellent Acoustical Values
- Available in straight or wavy bottom
- Custom Sizes Available

SPECIFICATIONS

Standard Baffle Sizes (WxH):	48"x 12", 48"x 16", 48"x 24" 96"x 12", 96"x 16", 96"x 24"
Thickness:	9 mm
Weight:	.5lbs. per square foot
Fire Rating:	Class A per ASTM E-84
Design:	Straight or Wavy Bottom Edge

HARDWARE OPTIONS

Product can be installed with your choice of either aircraft cable or threaded rod attachments.

ACOUSTICAL DATA

Frequency (Hz)	125	250	500	1000	2000	4000	SABINS
9 mm Thickness	1.17	1.40	2.17	3.39	4.89	5.74	

Frequency (Hz)	125	250	500	1000	2000	4000	NRC
9 mm Thickness	.29	.35	.54	.85	1.22	1.44	.75

Based on Baffle size 4' x 2' with Type "J" Mounting. Sabins are based on Sabins per Object, NRC is an equivalent number based on one face of one panel



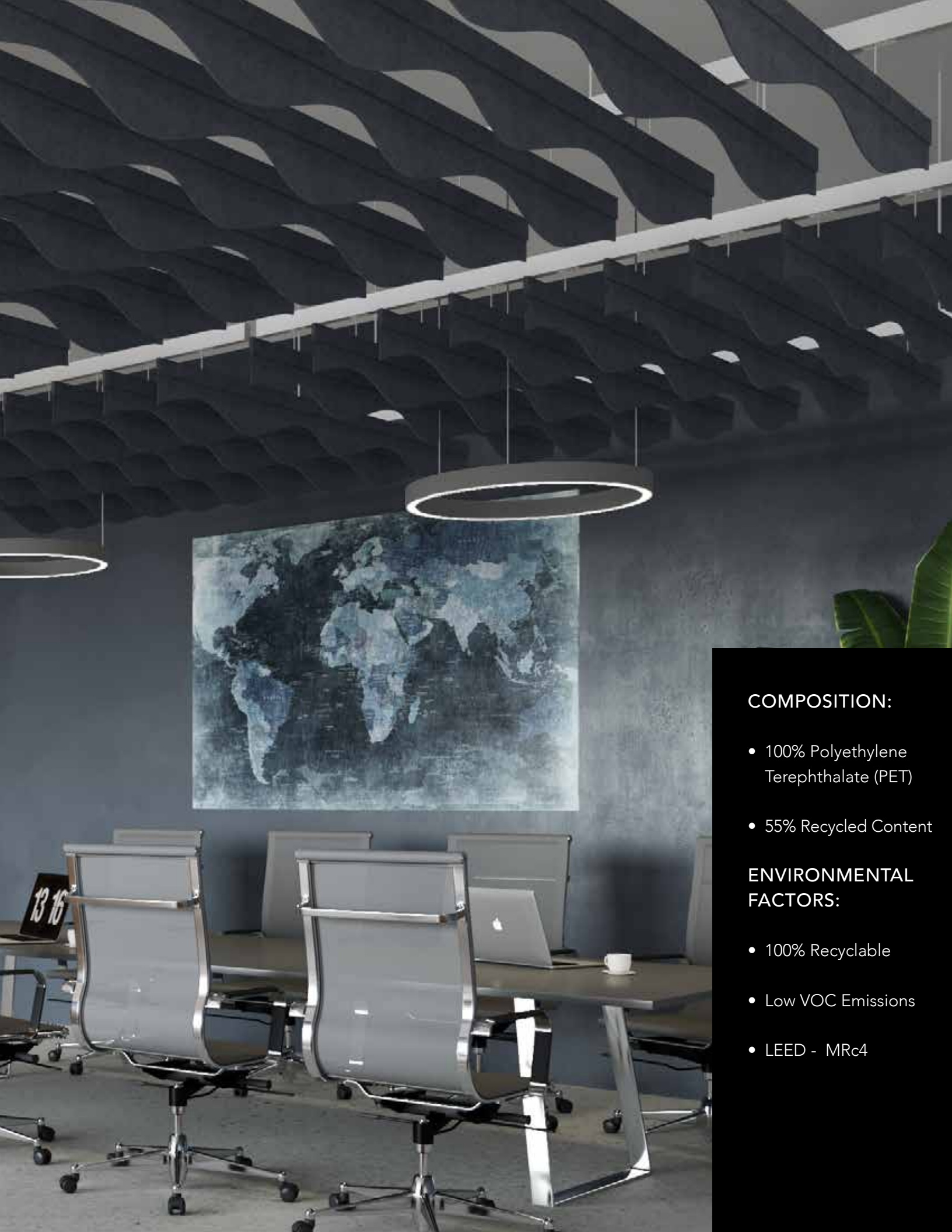

COMPOSITION:

- 100% Polyethylene Terephthalate (PET)
- 55% Recycled Content

ENVIRONMENTAL FACTORS:

- 100% Recyclable
- Low VOC Emissions
- LEED - MRc4

OBLIX™

FEATURES:

- Choice of 35 Colors
- Lightweight and Easy to Handle
- Modern Design
- Excellent Acoustical Values
- Repeatable Pattern

SPECIFICATIONS

Standard Baffle Size (LxWxH): 47" x 47" x 12"
Weight: 16 lbs.
Fire Rating: Class A per ASTM E-84

HARDWARE OPTIONS

Product can be installed with aircraft cable

ACOUSTICAL DATA

Frequency (Hz)	125	250	500	1000	2000	4000	SABINS
Oblix	1.17	11.31	15.60	21.20	28.71	33.39	

Frequency (Hz)	125	250	500	1000	2000	4000	NRC
Oblix	.43	.74	1.02	1.38	1.87	2.18	1.25

Based on Baffle size 4' x 4' with Type "J" Mounting. Sabins are based on Sabins per Object, NRC is an equivalent number based on one face of one panel



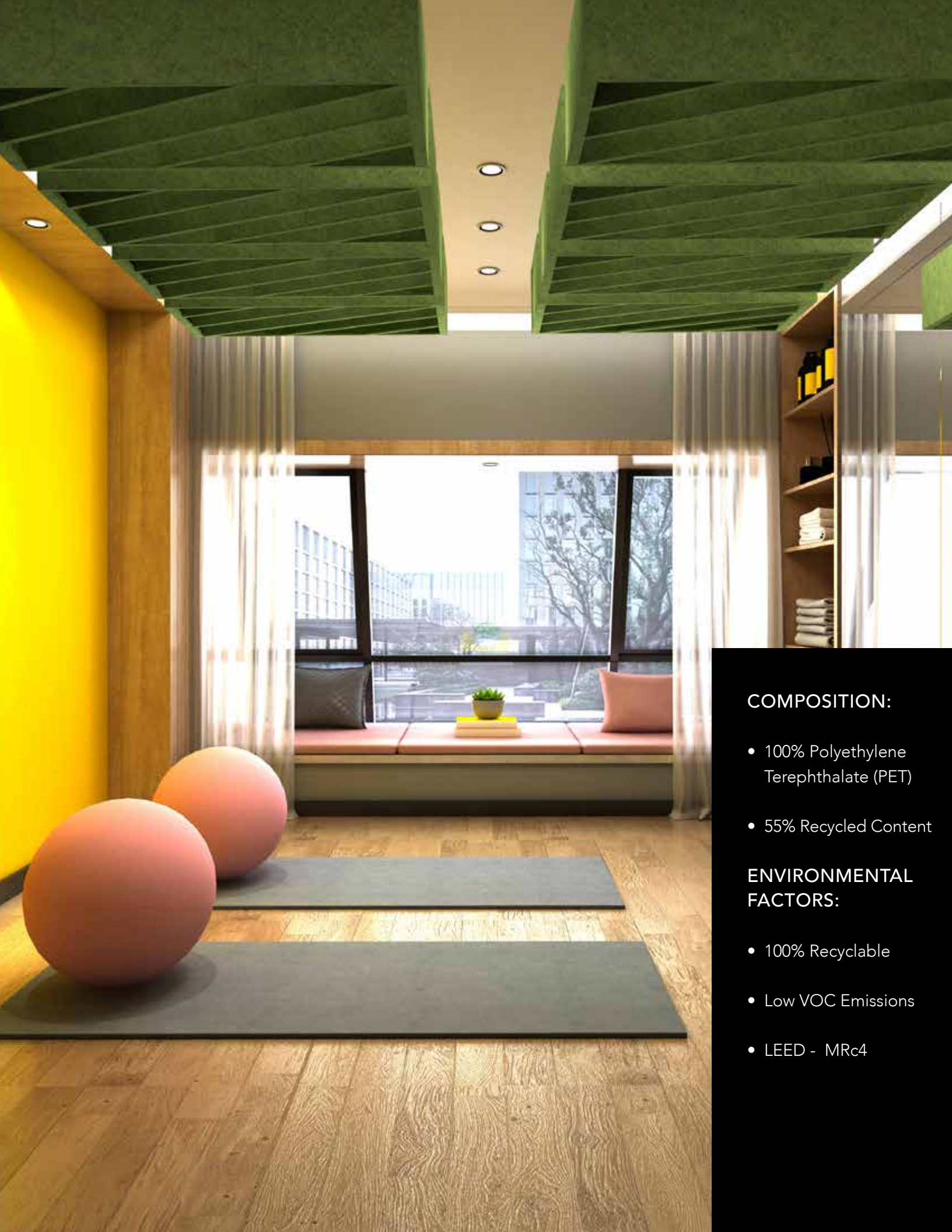

COMPOSITION:

- 100% Polyethylene Terephthalate (PET)
- 55% Recycled Content

ENVIRONMENTAL FACTORS:

- 100% Recyclable
- Low VOC Emissions
- LEED - MRc4

STRATUX CLOUD™

FEATURES:

- Easy Install
- Choice of 35 Colors
- Available in Circles and Squares

SPECIFICATIONS

Standard Cloud Sizes: 47" Diameter Circle or 47"x 47" Square
Thickness: 2-3/4"
Weight: 15 lbs./Cloud
Fire Rating: Class A per ASTM E-84

HARDWARE OPTIONS

Product can be installed with your choice of either aircraft cable or threaded rod attachments.

ACOUSTICAL DATA

Frequency (Hz)	125	250	500	1000	2000	4000	SABINS
2-3/4" Thickness	8.03	11.24	16.21	23.43	27.08	29.63	

Frequency (Hz)	125	250	500	1000	2000	4000	NRC
2-3/4" Thickness	.53	.74	1.06	1.54	1.77	1.94	1.30

Based on Cloud size 4' x 4' with Type "J" Mounting. Sabins are based on Sabins per Object, NRC is an equivalent number based on one face of one panel



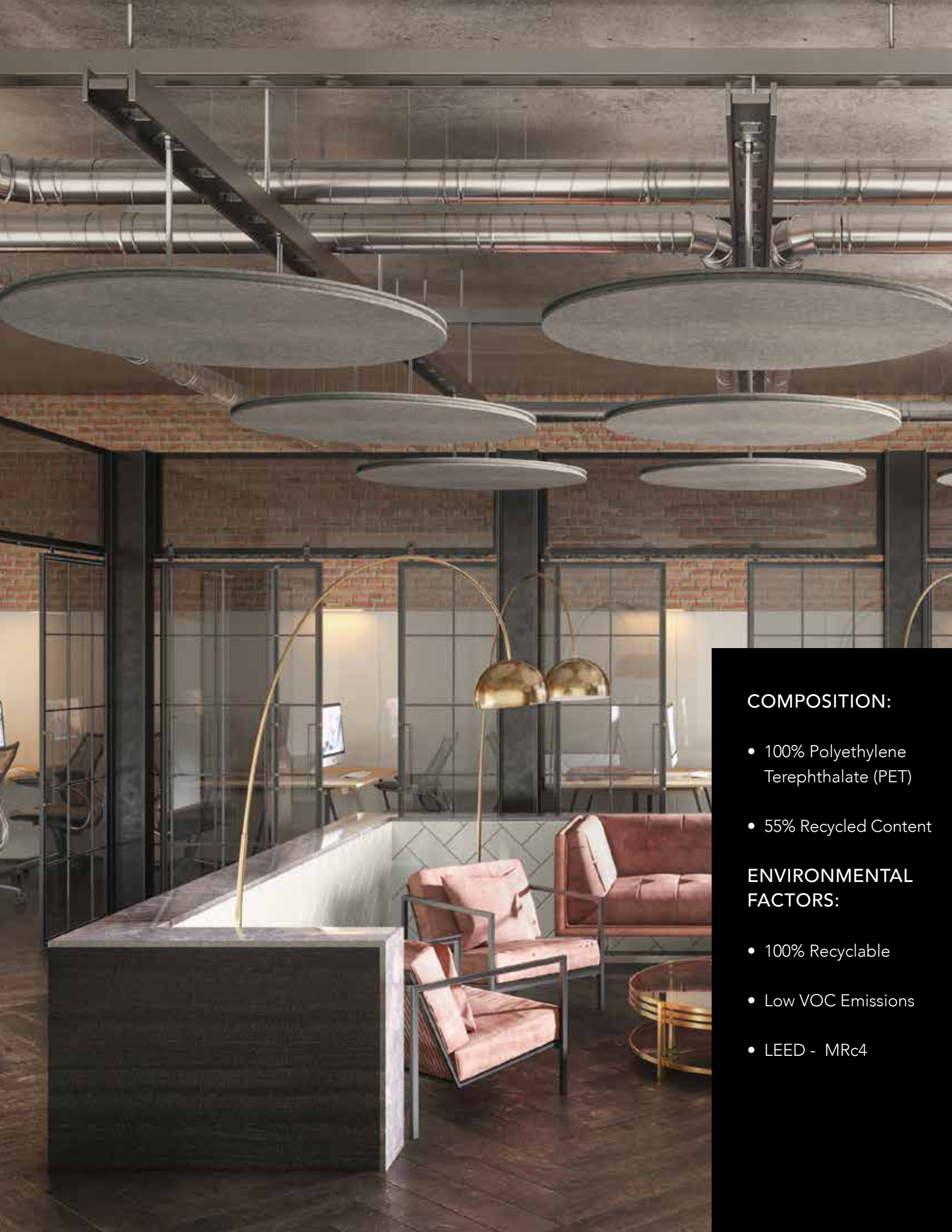

COMPOSITION:

- 100% Polyethylene Terephthalate (PET)
- 55% Recycled Content

ENVIRONMENTAL FACTORS:

- 100% Recyclable
- Low VOC Emissions
- LEED - MRc4

TETRIX™

FEATURES:

- Quick and Easy Installation
- Lightweight and Easy to Handle
- Choice of 35 Colors
- Chamfered Edge Detail

SPECIFICATIONS

Panel Sizes:	23-1/2"x 23-1/2" or 23-1/2"x 47"
Thickness:	9mm
Edge Detail:	Chamfered
Weight:	.25 lbs/SF
Fire Rating:	Class A per ASTM E-84

INSTALL METHODS:

Construction Panel Adhesive, Carpet Glue or Nail Clips with Adhesive

ACOUSTICAL DATA

Frequency (Hz)	125	250	500	1000	2000	4000	NRC
9mm Thickness	.04	.04	.16	.40	.63	.82	.30

Tested as Type "A" Mounting



POLY-COUSTIX®
BY SOUND SEAL

Distributed by:

WALLWORKS. ACOUSTIC. ARCHITECTURAL. PRODUCTS. INC.

sales@wallworks.com



COMPOSITION:

- 100% Polyethylene Terephthalate (PET)
- 55% Recycled Content

ENVIRONMENTAL FACTORS:

- 100% Recyclable
- Low VOC Emissions
- LEED - MRc4

TERIX- AIR™

FEATURES:

- Quick and Easy Installation with Hidden Access Panel
- Acoustical Felt
- Core designed with Air Cavity for Maximum Sound Absorption
- Choice of 35 Colors
- Multiple Size Configurations

SPECIFICATIONS

Panel Sizes:	10-1/2" x 10-1/2"
	21" x 10-1/2"
	21" x 21"
	42" x 21"
	42" x 42"
Thickness Options:	27mm, 36mm
Weight:	27mm: .30 lbs/SF, 36mm: .41 lbs/SF
Fire Rating:	Class A per ASTM E-84

ACOUSTICAL DATA

Frequency (Hz)	125	250	500	1000	2000	4000	NRC
27mm Thickness	.06	.12	.28	.61	.91	.99	.50

Tested as Type "A" Mounting



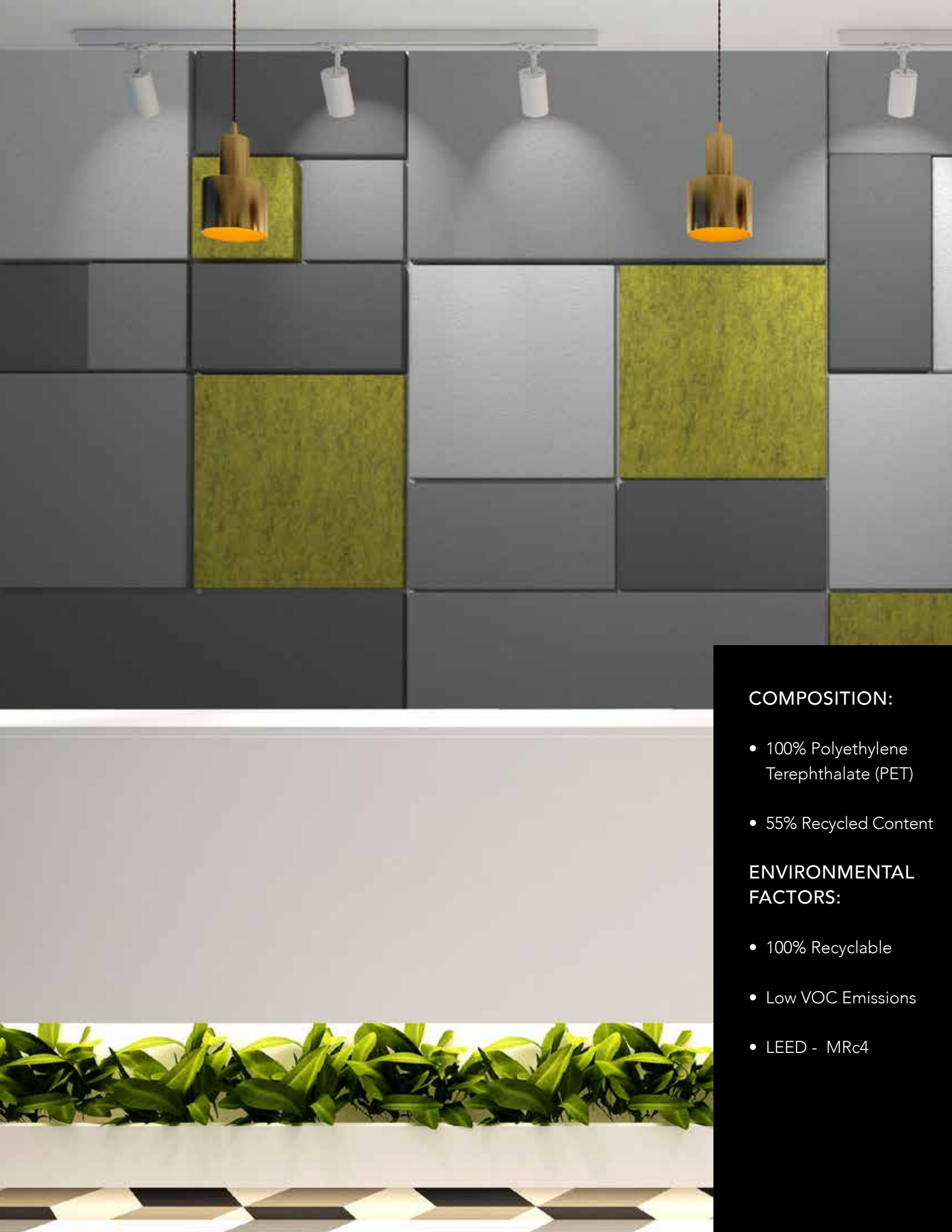

COMPOSITION:

- 100% Polyethylene Terephthalate (PET)
- 55% Recycled Content

ENVIRONMENTAL FACTORS:

- 100% Recyclable
- Low VOC Emissions
- LEED - MRc4

TRI-HEX™

FEATURES:

- Design Friendly Felt Material
- Choice of 35 Colors
- Quick-Mount Installation
- Multiple Configurations

SPECIFICATIONS

Standard Panel Size:	13" x 15"
Thickness:	5/8" (0.625")
Weight:	1 lb./Tile
Fire Rating:	Class A per ASTM E-84

INSTALL METHODS

Construction Panel Adhesive or Carpet Glue

ACOUSTICAL DATA

Frequency (Hz)	125	250	500	1000	2000	4000	NRC
5/8" Thickness	.03	.07	.29	.60	.76	.86	.45

Tested as Type "A" Mounting

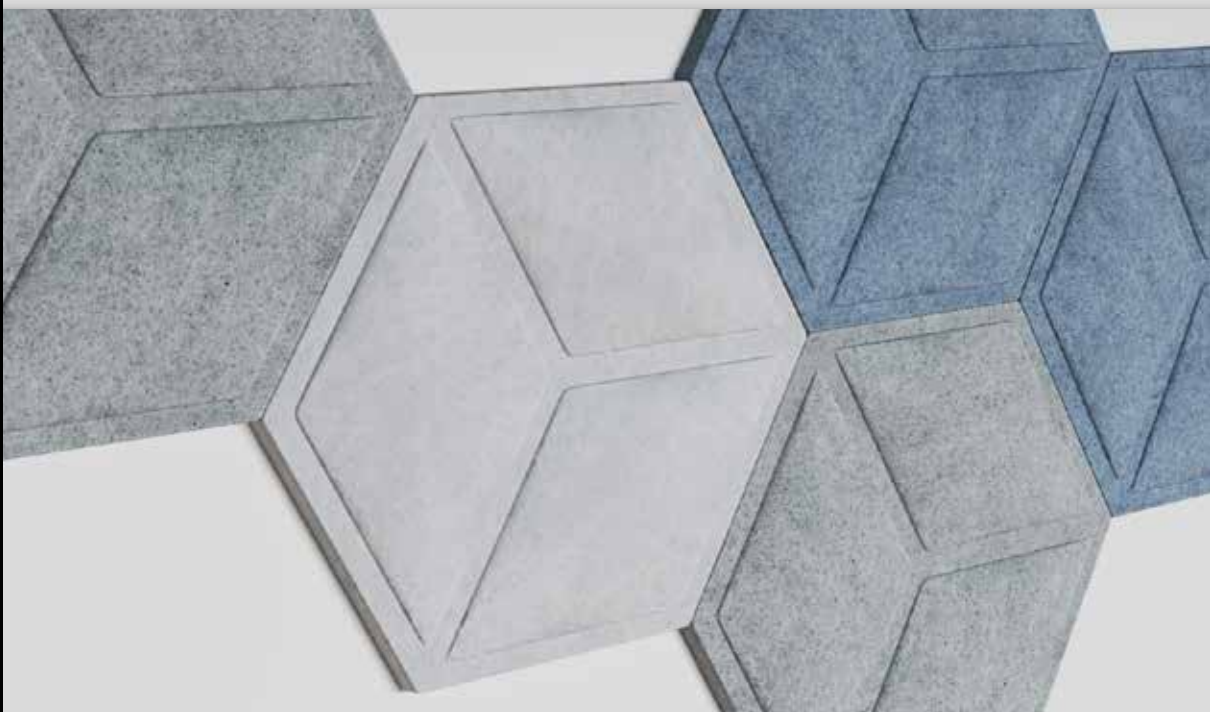



COMPOSITION:

- 100% Polyethylene Terephthalate (PET)
- 55% Recycled Content

ENVIRONMENTAL FACTORS:

- 100% Recyclable
- Low VOC Emissions
- LEED - MRc4

DIVIDEX™ PANEL

FEATURES:

- Easy Install
- Choice of 35 Colors
- Variety of Solid and Pattern Sections
- Lightweight and Easy to Handle
- Panels can be Stationary or Moveable
- Other Sizes Available

DIVIDEX™ PANELS ARE A GREAT WAY TO:

- Divide a Space
- Creatively Add Acoustical Absorption
- Personalize Your Space
- Add Privacy



SPECIFICATIONS

Standard Panel Size:	47"x 95"
Thickness:	9mm
Weight:	10 lbs/Panel
Fire Rating:	Class A per ASTM E-84

INSTALL METHOD

Hardware can be installed via your choice of aircraft cable/wire or threaded rod.

HARDWARE INCLUDED

Product comes with strips top and bottom and embedded hardware.

ACOUSTICAL DATA

Frequency (Hz)	125	250	500	1000	2000	4000	NRC
9mm Thickness	.29	.35	.54	.85	1.22	1.44	.75

Tested as a Type "J" Mounting. Based on panel size 4'x1'. NRC is an equivalent number based on one face of one panel. Based on solid panels with no patterns.

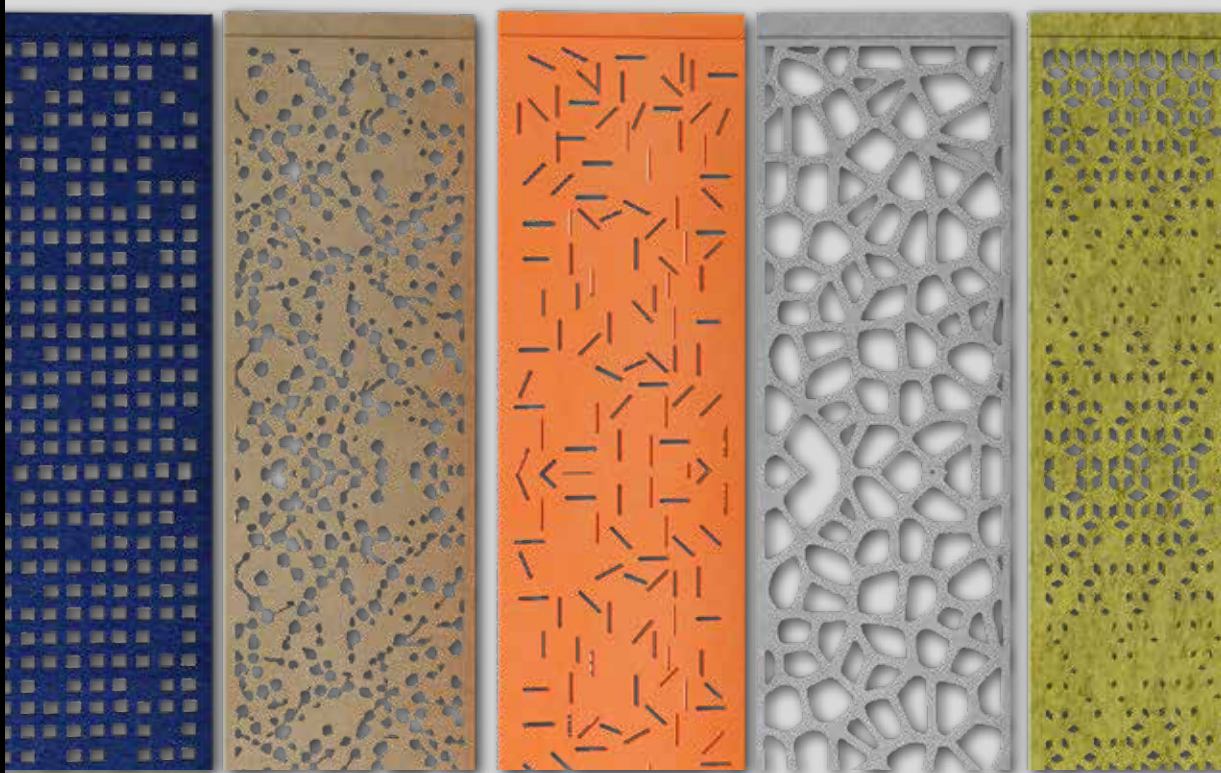

Distributed by:

WALLWORKS. ACOUSTIC. ARCHITECTURAL. PRODUCTS. INC.
sales@wallworks.com



COMPOSITION:

- 100% Polyethylene Terephthalate (PET)
- 55% Recycled Content

ENVIRONMENTAL FACTORS:

- 100% Recyclable
- Low VOC Emissions
- LEED - MRc4





TETRIX-AIR™

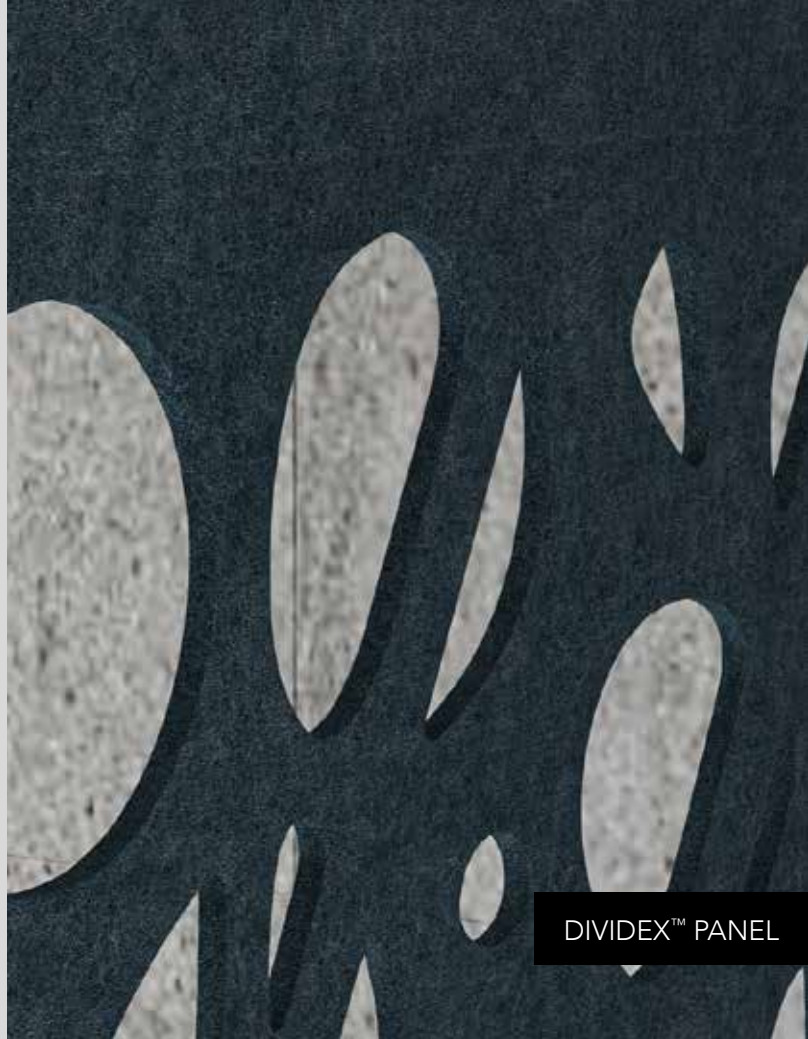

DIVIDEX™ PANEL

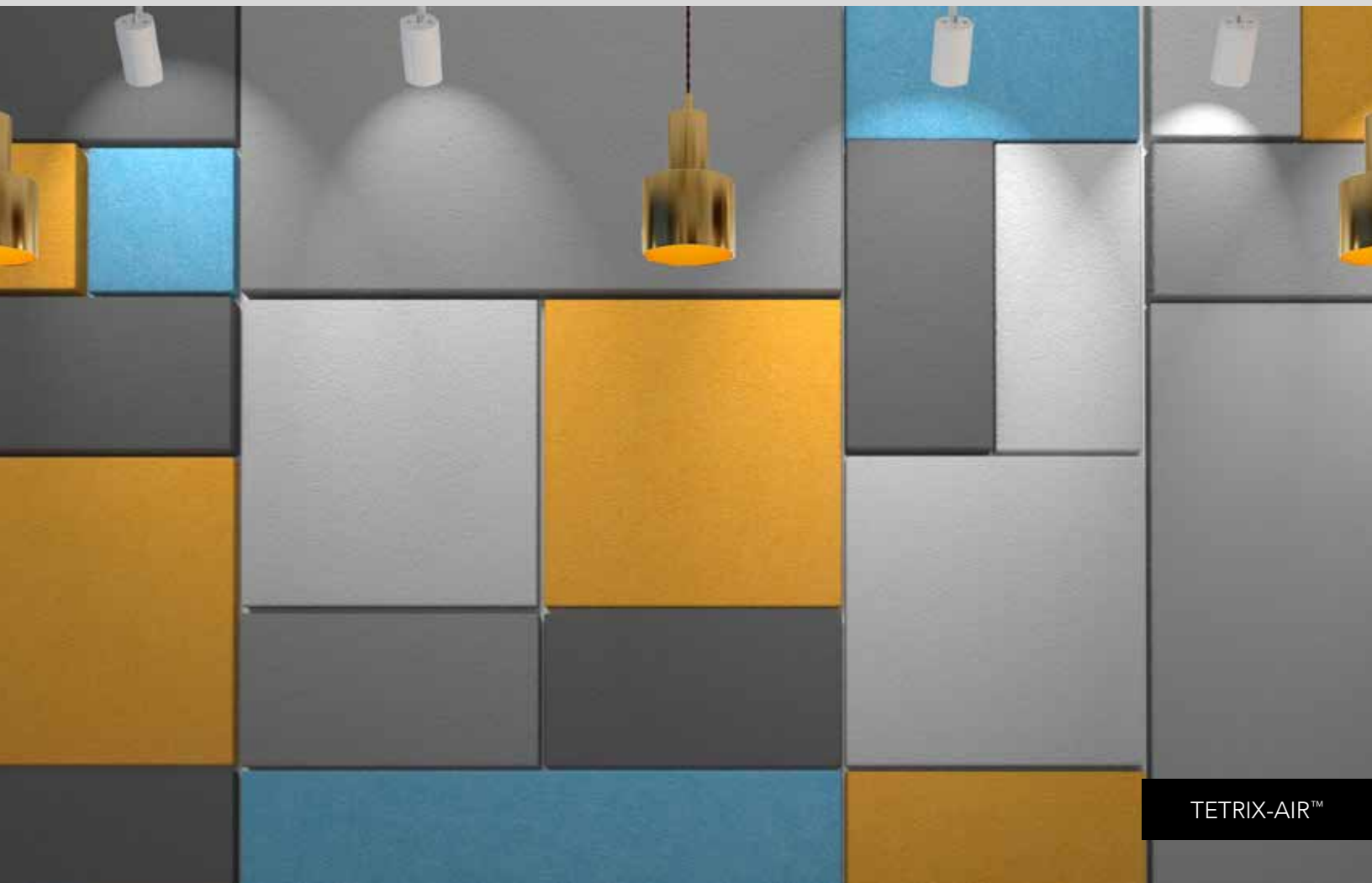

TETRIX-AIR™



POLY-COUSTIX®

BY SOUND SEAL



ALL POLY-COUSTIX PRODUCTS ARE
RED LIST FREE, RoHS AND REACH COMPLIANT



Distributed by:

WALLWORKS. ACOUSTIC. ARCHITECTURAL. PRODUCTS. INC.
sales@wallworks.com